

# 400 SERIES

## OVERLAY SPECIFICATIONS

### MODEL 424 – OVERLAY PANELS

The overlay panels applied to the Model 424 should not be confused with the 600 Series overlay panel application. The Model 424 panel will consist of only a frame and would be either the 5/8-inch or 3/4-inch panel you may be using. It is affixed directly to the door itself with screws through a series of pre-drilled holes in the perimeter of the door itself. You do not need any backer or spacer panel.

Refer to illustrations 3 and 4 to give you a better idea of the exact space our unit needs and how the panel fits in relationship with the unit.

The glass door opening of the standard Model 424 is designed to be exposed to room air circulation. Decorative overlays on the glass should be kept to a minimum. Also, rails and stiles can be increased in size but should not exceed cabinet manufacturers standard width. They cannot exceed overall door panel dimensions specified, as they would interfere with the operation of the door. The back sides of rails and stiles that will be visible through the glass door will need to be finished. Also, the inside edges of the frames must be finished to match the front surface.

Please note on the left-hand side of the overall unit dimensions where we have located pre-drilled holes for our optional handle hardware. Refer to illustration 14 for specifics about installing handle hardware on this overlay application.

Other installation instructions will be provided in complete detail in a book, which accompanies each unit.

**IMPORTANT NOTE:** Weight limit on solid door panels is 20 pounds. Solid door panels must not be installed on glass doors.

### Overlay Panel Specifications – Model 424

Door Panel (W x H)	23 <sup>3</sup> / <sub>8</sub> " x 30 <sup>1</sup> / <sub>16</sub> "
Minimum Width of Rails and Stiles	2 <sup>1</sup> / <sub>4</sub> "
Door Panel Weight Limit	10 lbs.
Minimum Panel Thickness	5/8"

### MODEL 424 – DOOR OPENING

When planning to install the Model 424 next to adjoining cabinetry, you must make provisions to allow the door to open to a maximum of 145° and not hit the door panel. Please refer to full-scale illustration 16, at the end of this section.

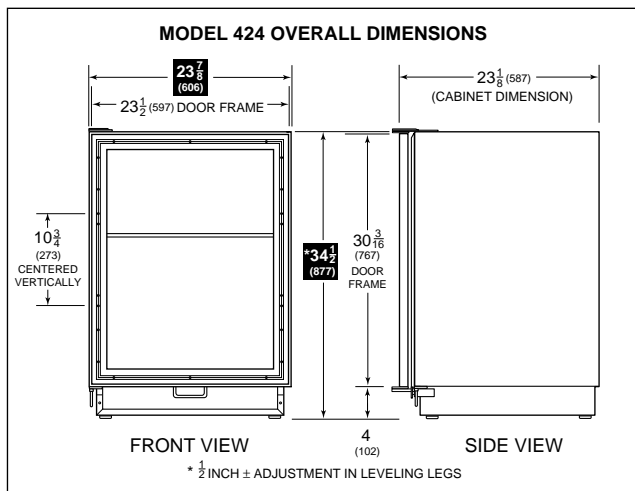

Illus. 3

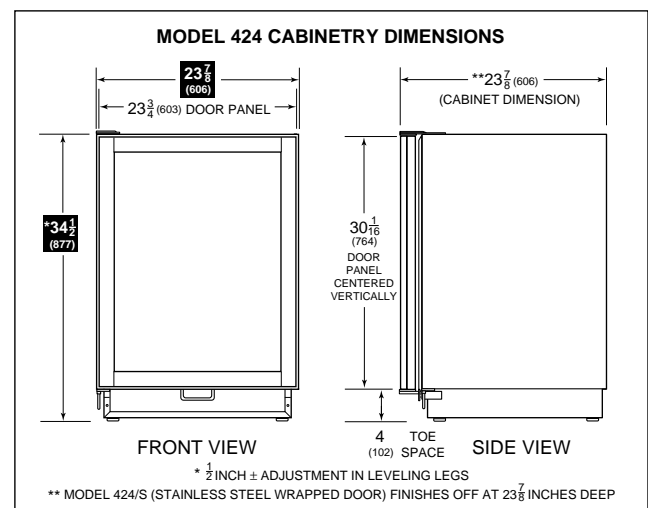

Illus. 4

# 400 SERIES

## 430 OVERLAY PANELS

Your overlay unit will be shipped without handle hardware and with an 11-inch overlay panel grille as standard equipment. You will need to order a panel for the grille and hardware to complement your surrounding cabinetry.

While the overlay panel design offers you a more seamless appearance, you need to be aware of adjacent cabinets and/or countertops when the door is opened. Refer to the full-scale illustrations at the end of this section.

To achieve the overlay look, you need three different panels – the decorative overlay panel, a .10-inch spacer panel and a 1/4-inch backer panel. Depending on your cabinet manufacturer, this could be one panel routed for different dimensions or more likely, three different panels. Refer to the Overlay Panel Specifications charts for complete details on the overlay sizing. In addition, illustrations 12 and 13 will give you a better idea of the panel construction and how it interacts with our frame.

The glass door opening of the standard Model 430 is designed to be exposed to room air circulation. Decorative overlays on the glass should be kept to a minimum. Also, rails and stiles can be increased in size but should not exceed cabinet manufacturers standard width. They cannot exceed overall door panel dimensions specified, as they would interfere with the operation of the door.

The back sides of rails and stiles that will be visible through the glass door will need to be finished. Also, the inside edges of the frames must be finished to match the front surface.

If you are using a solid door, you would not order a frame but follow only the overall panel sizing of the framed and overlay applications.

As with all Sub-Zero 600 Series equipment, you have the flexibility of ordering larger panel grilles for either the framed or overlay applications. For specific panel sizing on these optional grilles for either the framed or overlay applications of the Model 430, please refer to the 600 Series Overlay Panel section for additional detail. In addition, side panel information for a Model 430 is available in this section.

### Overlay Panel Specifications – Model 430

Overlay Door Panel (W x H)	28 <sup>7</sup> / <sub>16</sub> " x 68"
Spacer Panel (W x H)	27 <sup>1</sup> / <sub>2</sub> " x 67 <sup>1</sup> / <sub>16</sub> "
Backer Panel (W x H)	28 <sup>1</sup> / <sub>8</sub> " x 67 <sup>1</sup> / <sub>16</sub> "
Minimum Width of Rails and Stiles	2 <sup>1</sup> / <sub>4</sub> "
Door Panel Weight Limit	25 lbs.
Minimum Panel Thickness	5/ <sub>8</sub> "

### Grille Panel Specifications – Model 430

Overlay Grille Panel (W x H)	28 <sup>7</sup> / <sub>16</sub> " x 10 <sup>1</sup> / <sub>4</sub> "
Spacer Panel (W x H)	27 <sup>1</sup> / <sub>2</sub> " x 9 <sup>5</sup> / <sub>16</sub> "
Backer Panel (W x H)	28 <sup>1</sup> / <sub>8</sub> " x 9 <sup>5</sup> / <sub>16</sub> "
Grille Panel Weight Limit	15 lbs.
Minimum Panel Thickness	5/ <sub>8</sub> "

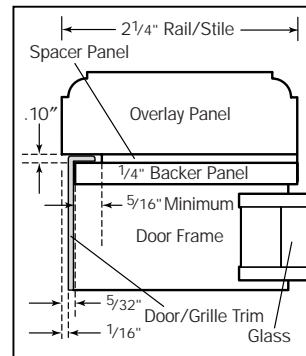

Illus.12

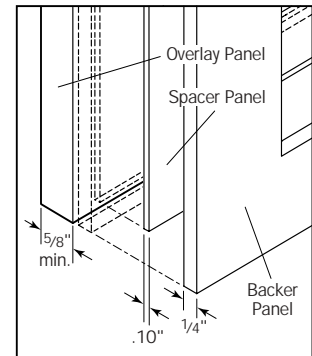

Illus.13

## WINE SHELF WOOD MOLDING DIMENSIONS

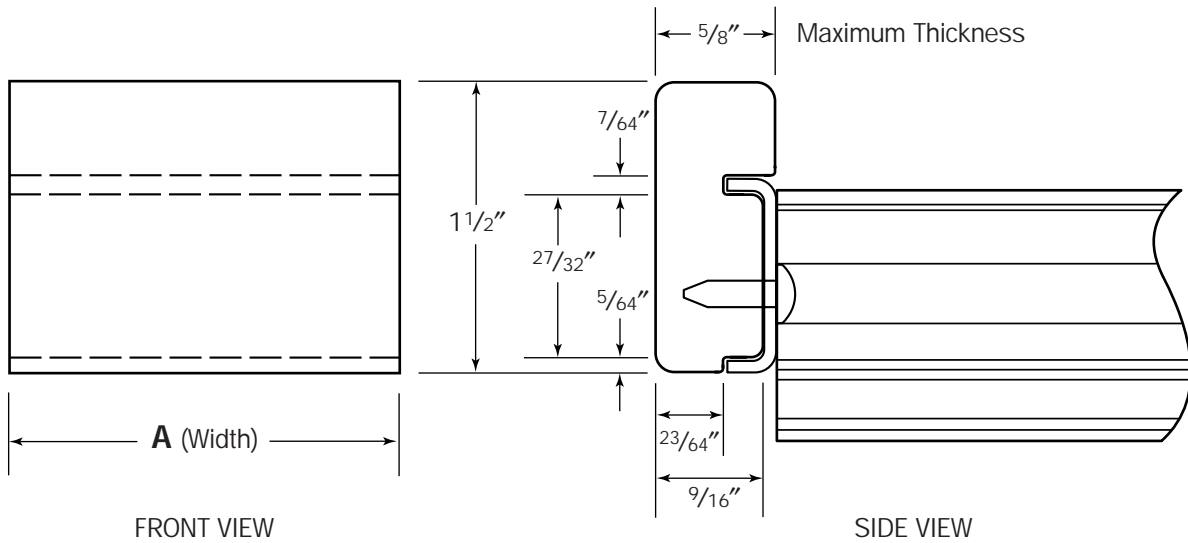

Illus. 15

### Wine Shelf Wood Molding – Dimension (A)

Model 424/424FS	$19\ 1/2''$
Model 427	$20\ 15/16''$
Model 427R	$20\ 15/16''$
Model 430	$24\ 9/16''$

### WOOD FACING – WINE SHELVES

Sub-Zero has provided a natural cherry wood facing to each of its wine shelves in each model. If, however, you would like to replace these strips with wood more complementary to your design and surrounding cabinetry, you can.

Illustration 15 can be used as a full-scale template. You must follow the layout of this format to accommodate the shelves properly. To remove the cherry strips, take the shelves out and merely remove the screws. Reverse the procedure to affix the new wood.

If you choose to stain or seal the wood facing, be aware that some of these substances are hazardous and will damage stored wine.

## 400 SERIES DOOR FRAME DIMENSIONS

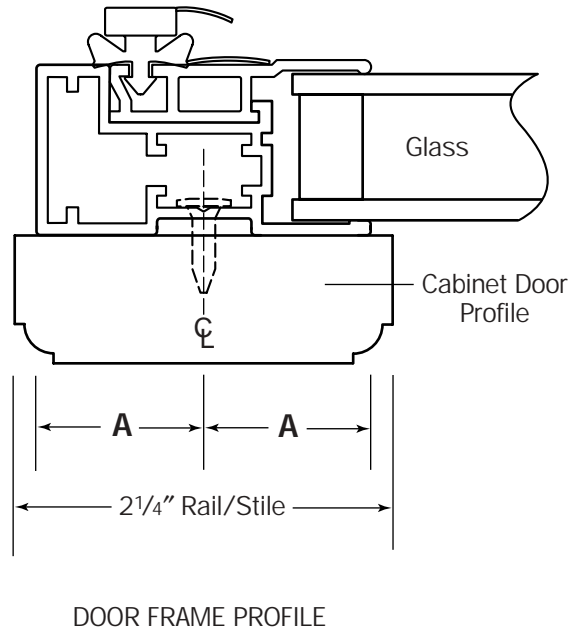

Illus. 14

### HARDWARE CONSIDERATIONS

With the Model 424 (overlay), Models 427 and 427R (integrated) and Model 430 (overlay), you must supply your own handle hardware. It is recommended you use our optional handles and use the pre-drilled holes supplied to locate the handles within the frame of our unit. This will allow you to provide the best possible handle alignment and not take away from the strength of the stile in this area after the unit is used a number of times.

If you elect to place different hardware on these units, we encourage you to fasten the hardware by passing through our door and attach the hardware through the Sub-Zero door's frame.

Optional stainless steel handles are available in a variety of diameters and lengths, as well as handles to match the color and style of Wolf ovens. Contact your Sub-Zero distributor for specifics.

### Door Frame Handle Offset – Dimension (A)

Model 424	1"
Model 427	7/8"
Model 427R	7/8"
Model 430	15/16"

**IMPORTANT NOTE:** Rails and stiles must be a minimum of 2<sup>1</sup>/<sub>4</sub> inches wide (except for the rails of Models 427 and 427R, which must be wide enough to cover the door hinges). The back sides of rails and stiles that will be visible through the glass door will need to be finished.

NOTE: Illustration 14 is typical of the Model 424 door frame profile, details of the other 400 Series door frames will vary slightly.

### ⚠ CAUTION

When planning for hardware, please refer to full-scale illustration 14 to give you a better understanding of the unit's frame and positioning of the glass for the door. You must not drill through this glass.

**INSTALLATION OF MODEL 424  
(FULL SCALE)  
DOOR CLOSED AND  
145° MAXIMUM DOOR SWING**

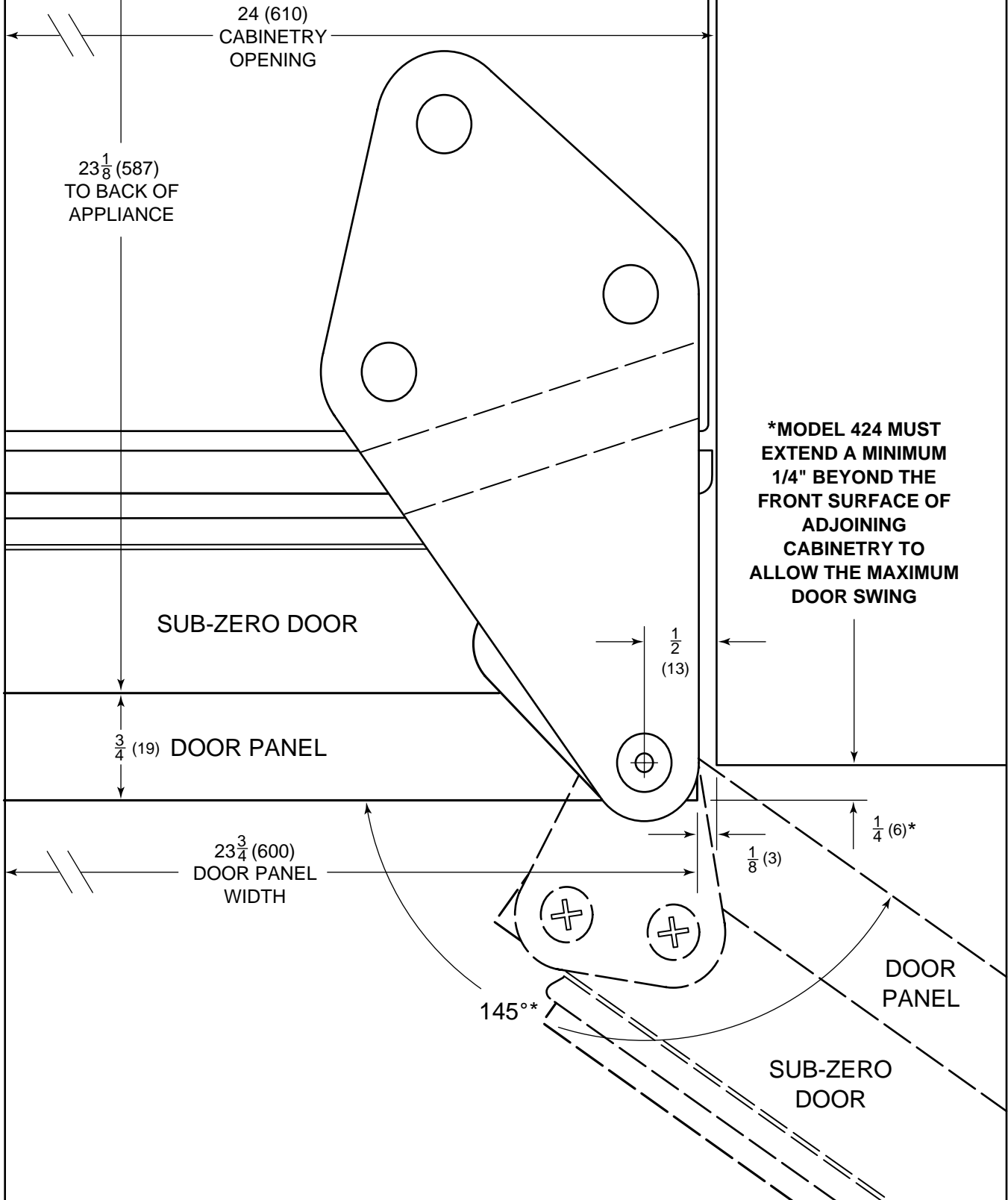

Illus.16